

Equator-X part temperature sensor (A-6620-1520)

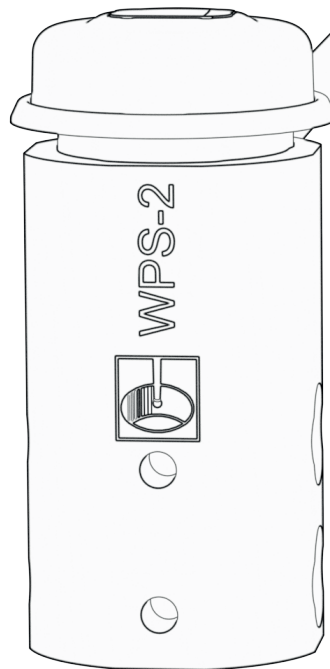

Introduction

The Equator-X part temperature sensor is used to measure the temperature of parts on the Equator-X system. The following information will help to get the best performance from the sensor:

1. For best accuracy, the contact surface on the part should be flat and smooth.
2. The sensor can be installed vertically or horizontally using the supplied pin or bolts. The pin is also compatible with Renishaw fixturing components to allow for any height, angle or position.
3. The overall sprung range of the sensor is 4 mm and so the nominal deflection should be in the middle of this travel, i.e. the sensor should be adjusted so that it is contacting the part by 2 mm.

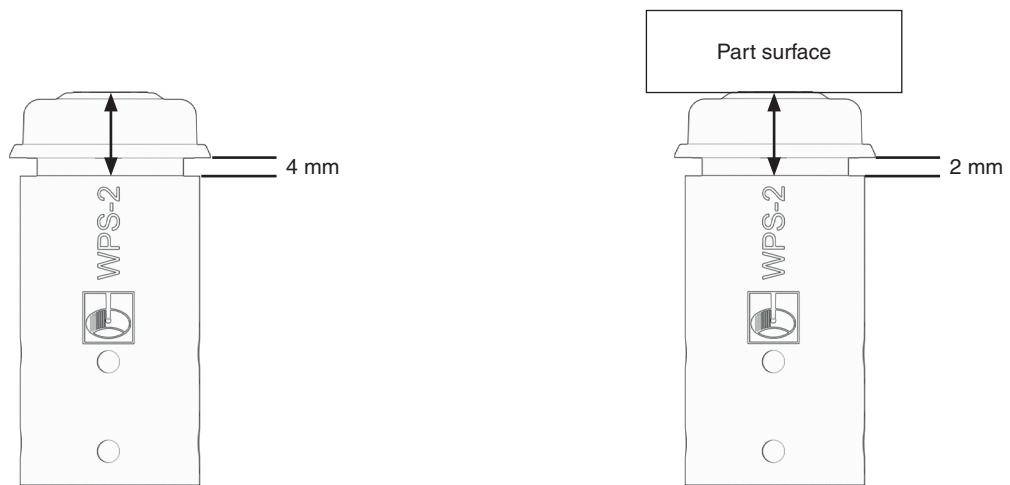

4. The pin allows for 10 mm of vertical movement to allow the exact setting of the 2 mm deflection.

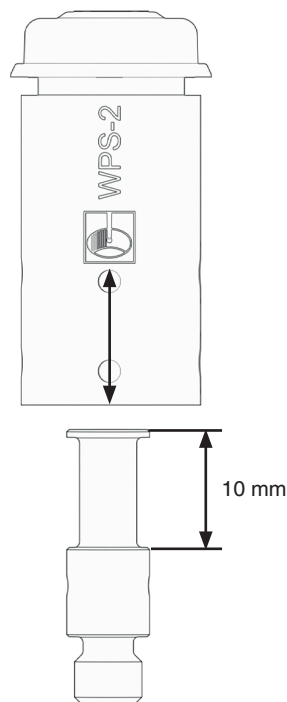

Kit contents

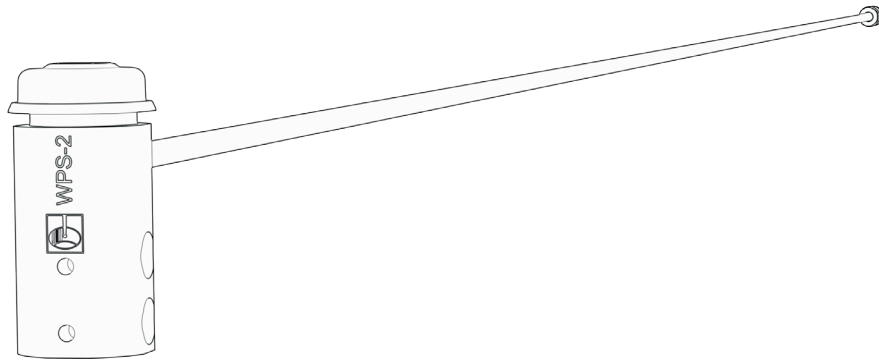

Part temperature sensor x1



Pin x1



M4x20 Button bolt x2

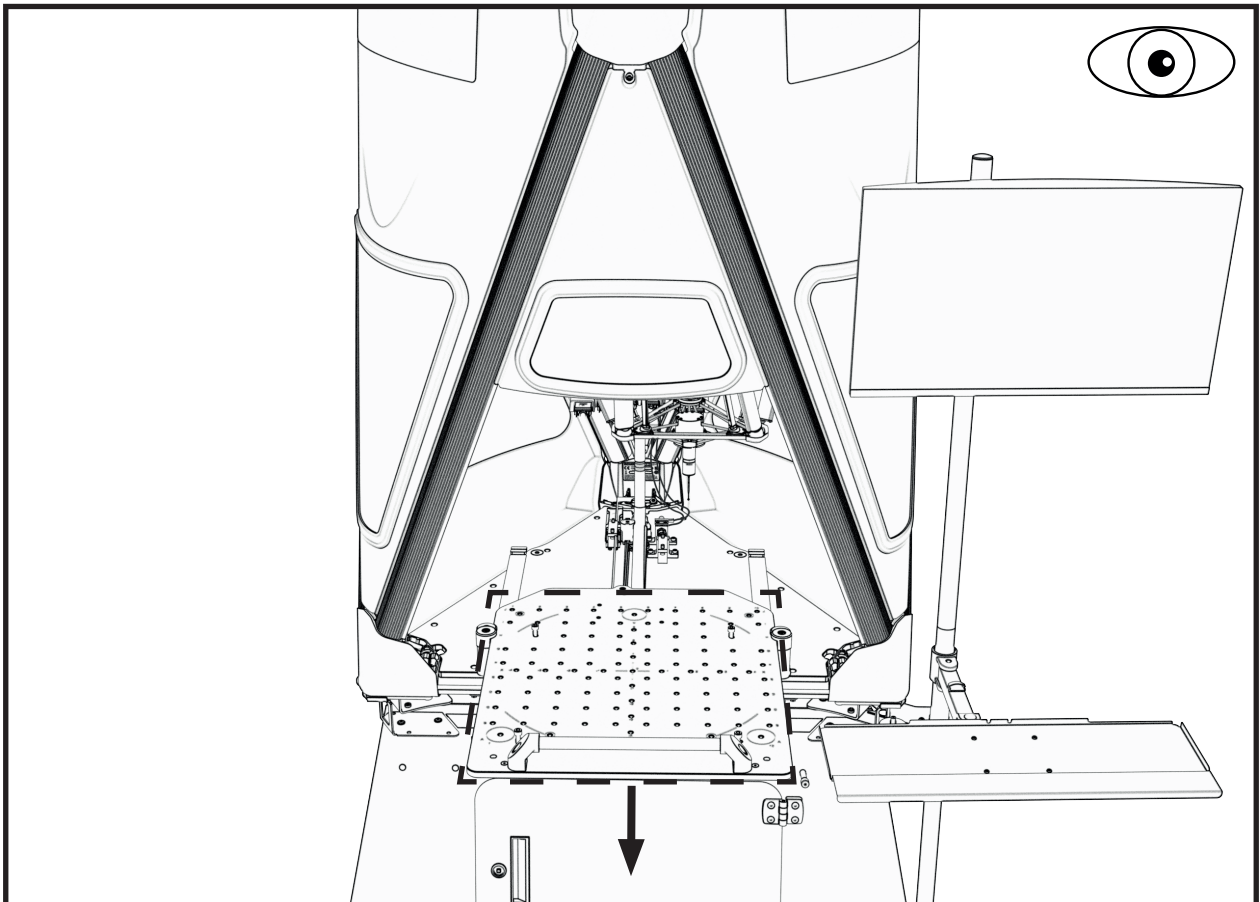

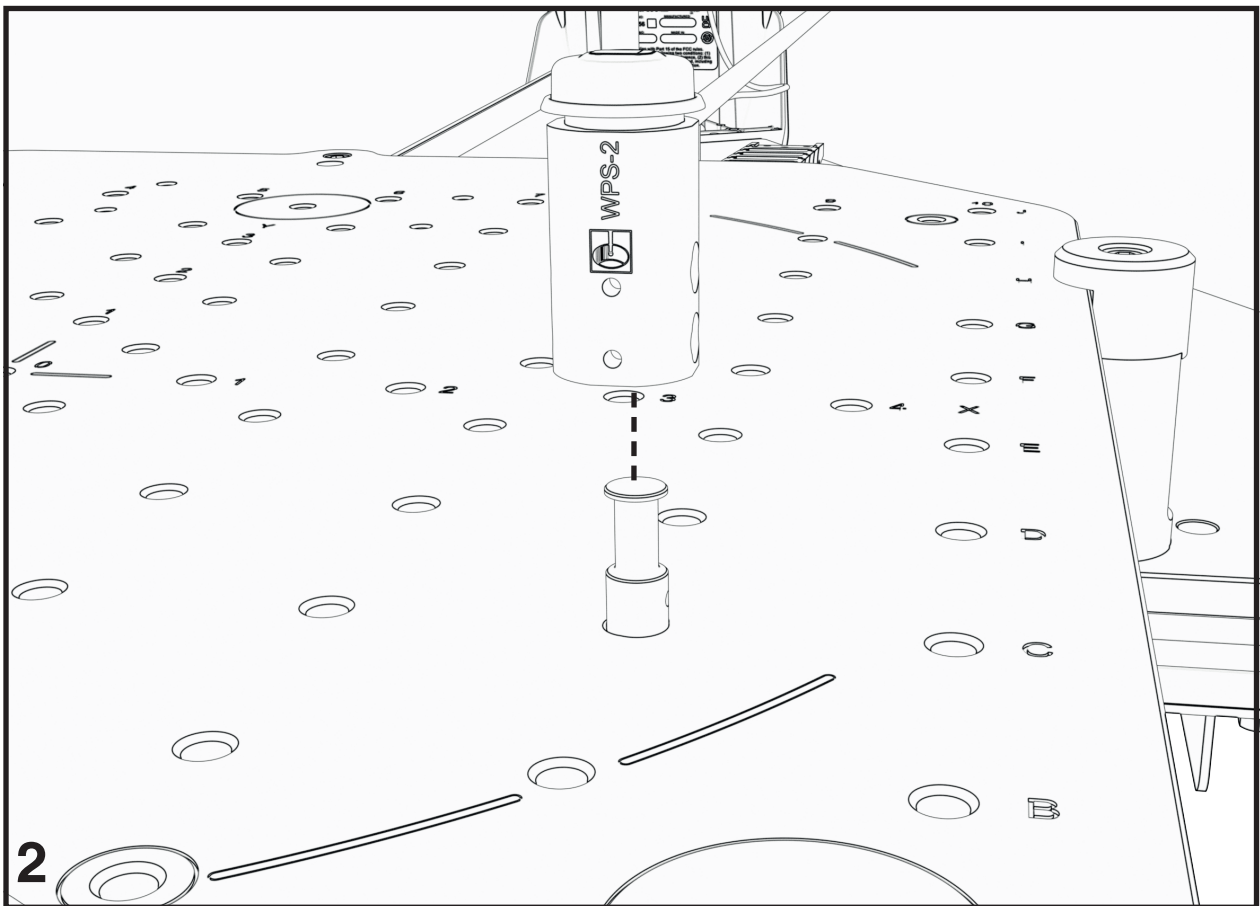
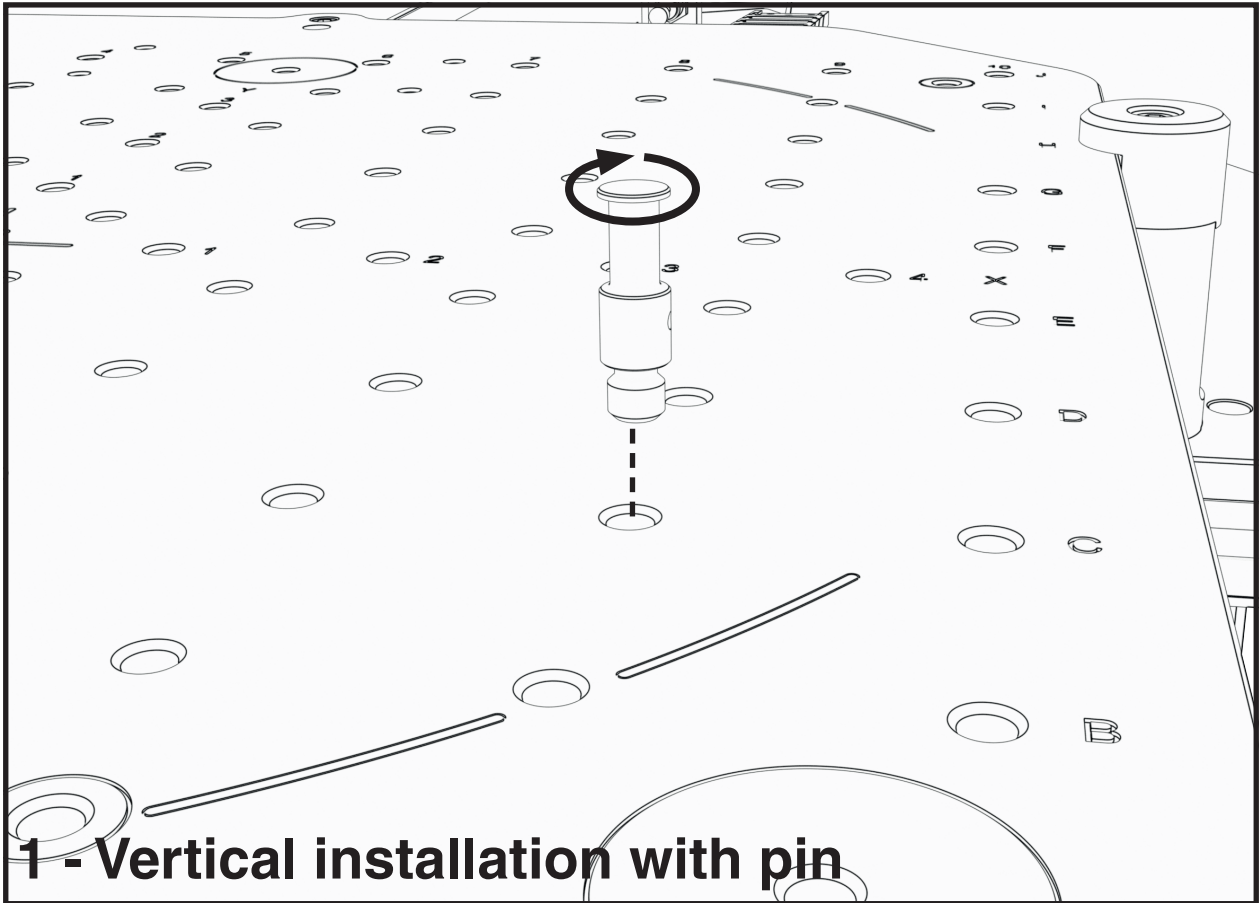

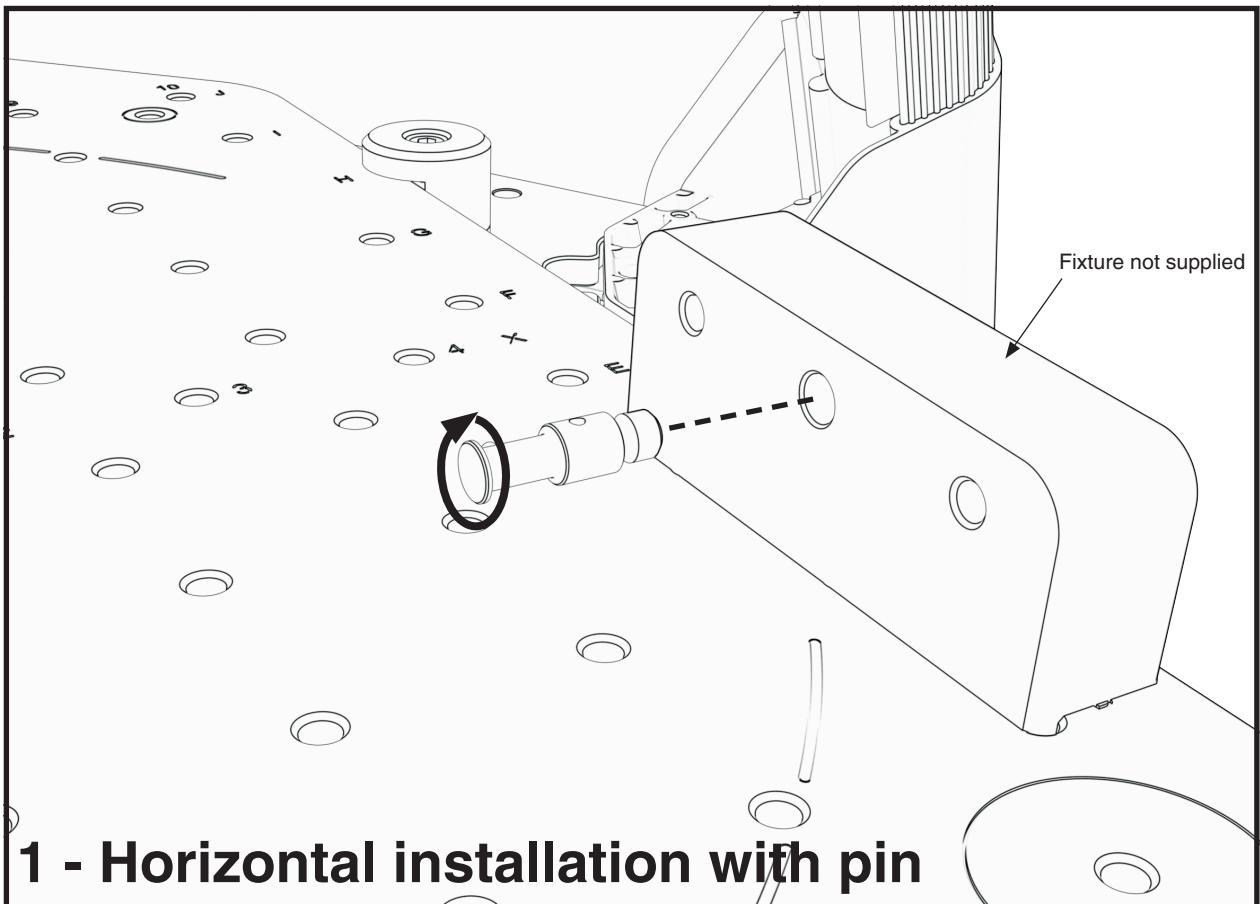
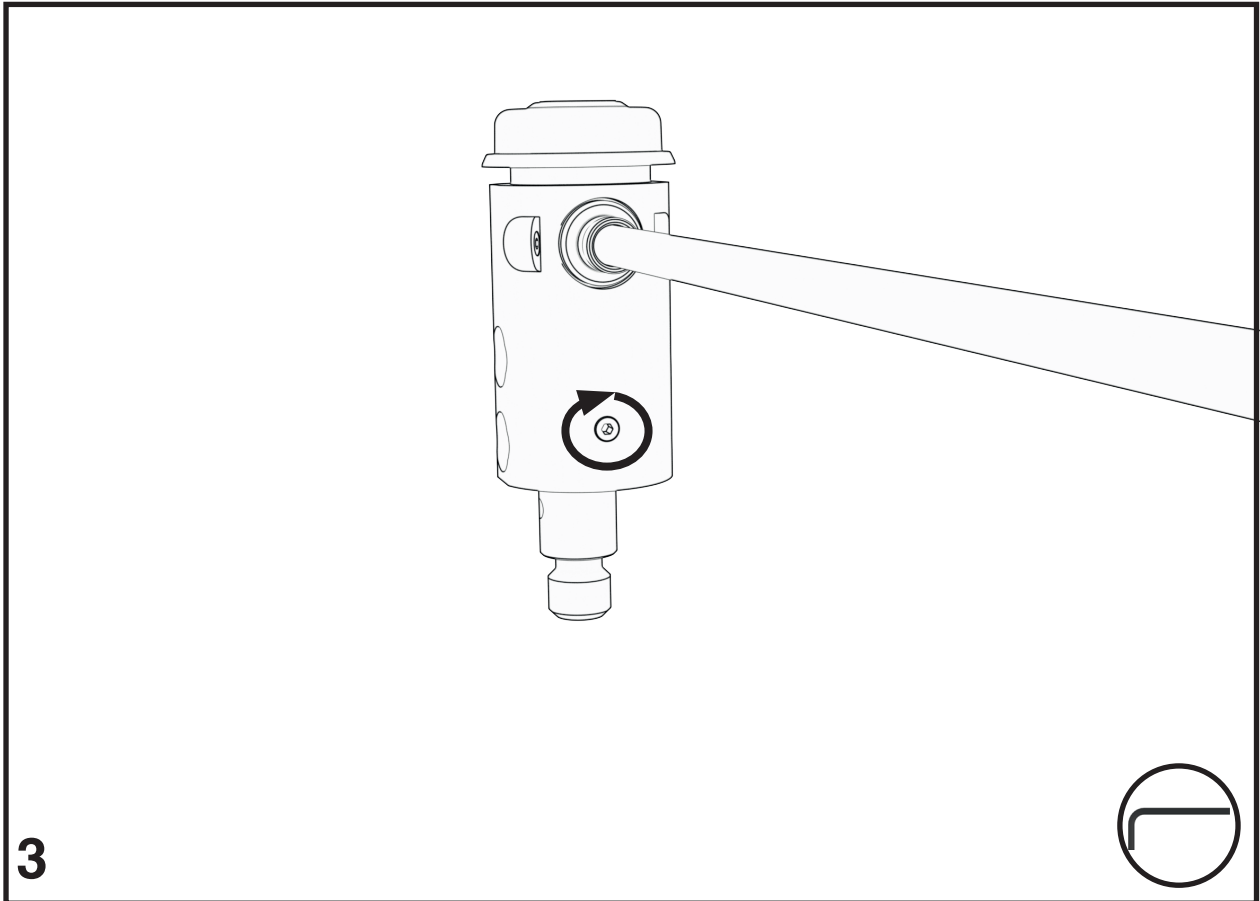

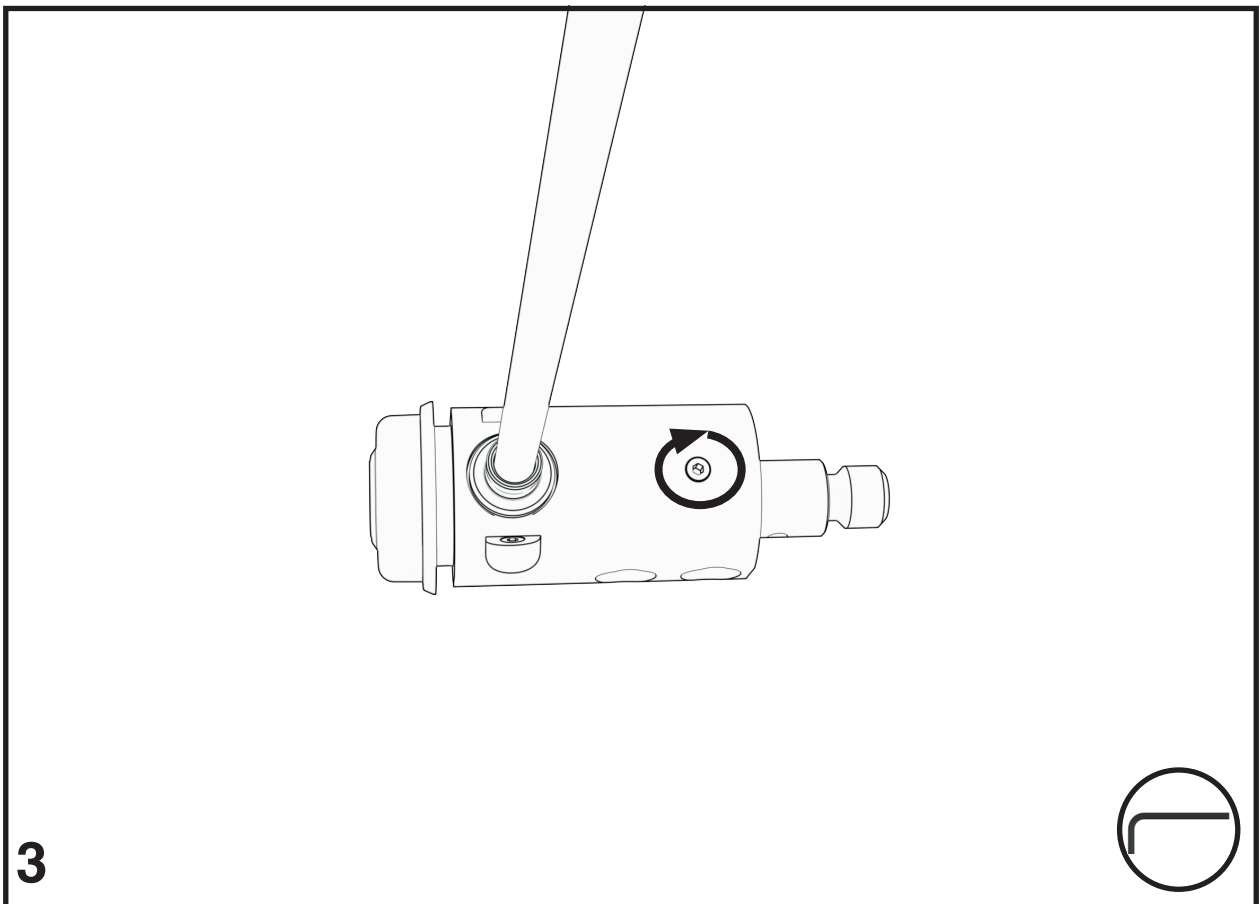
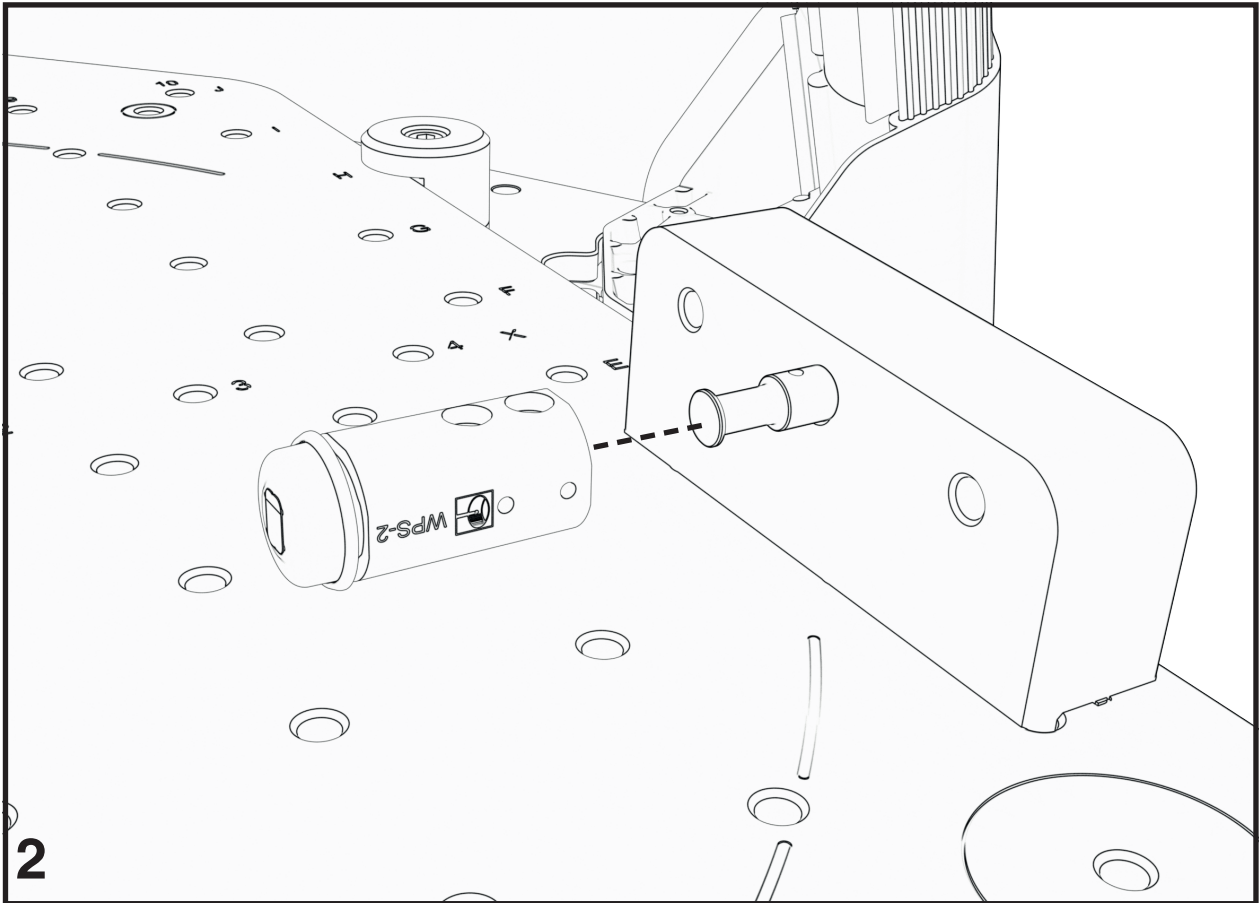

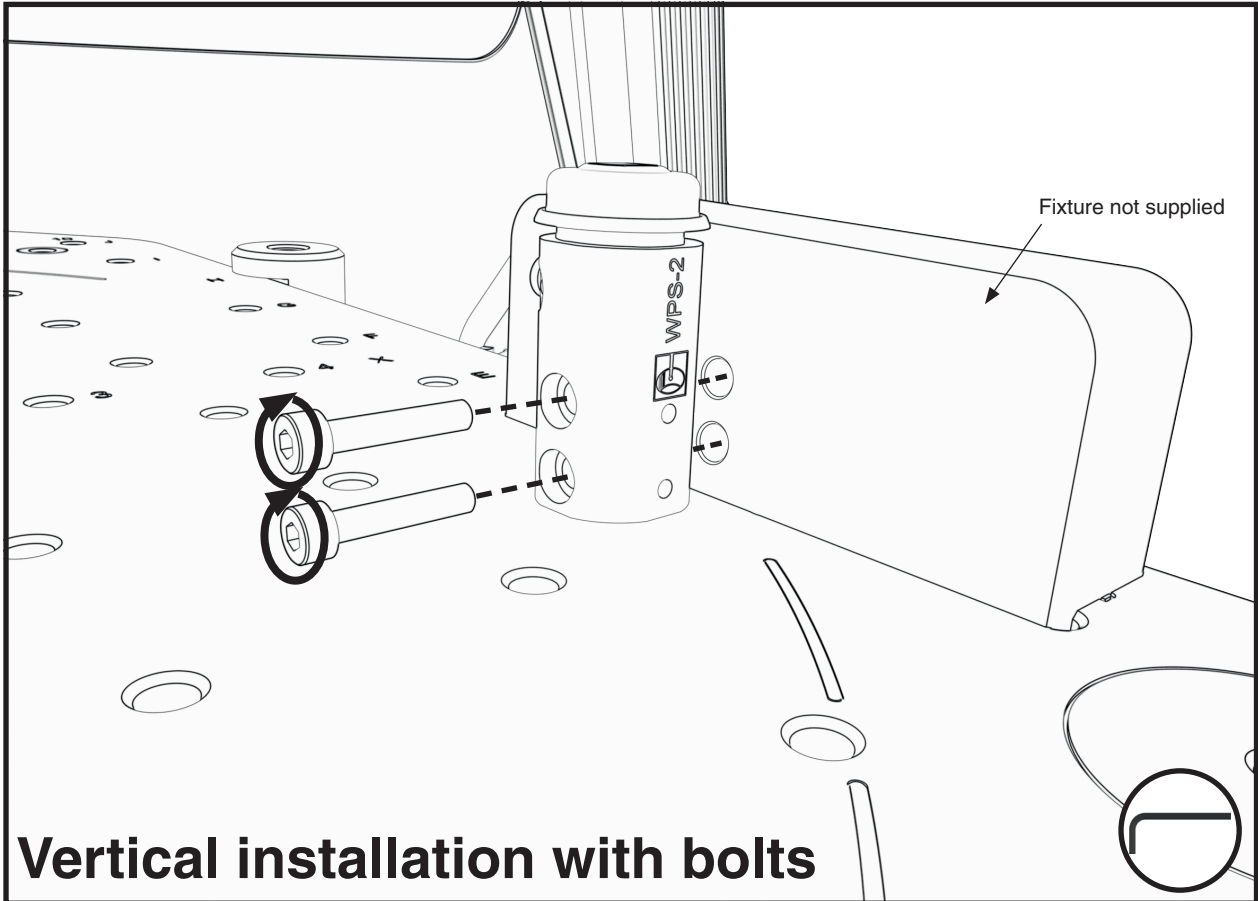

Vertical installation with bolts

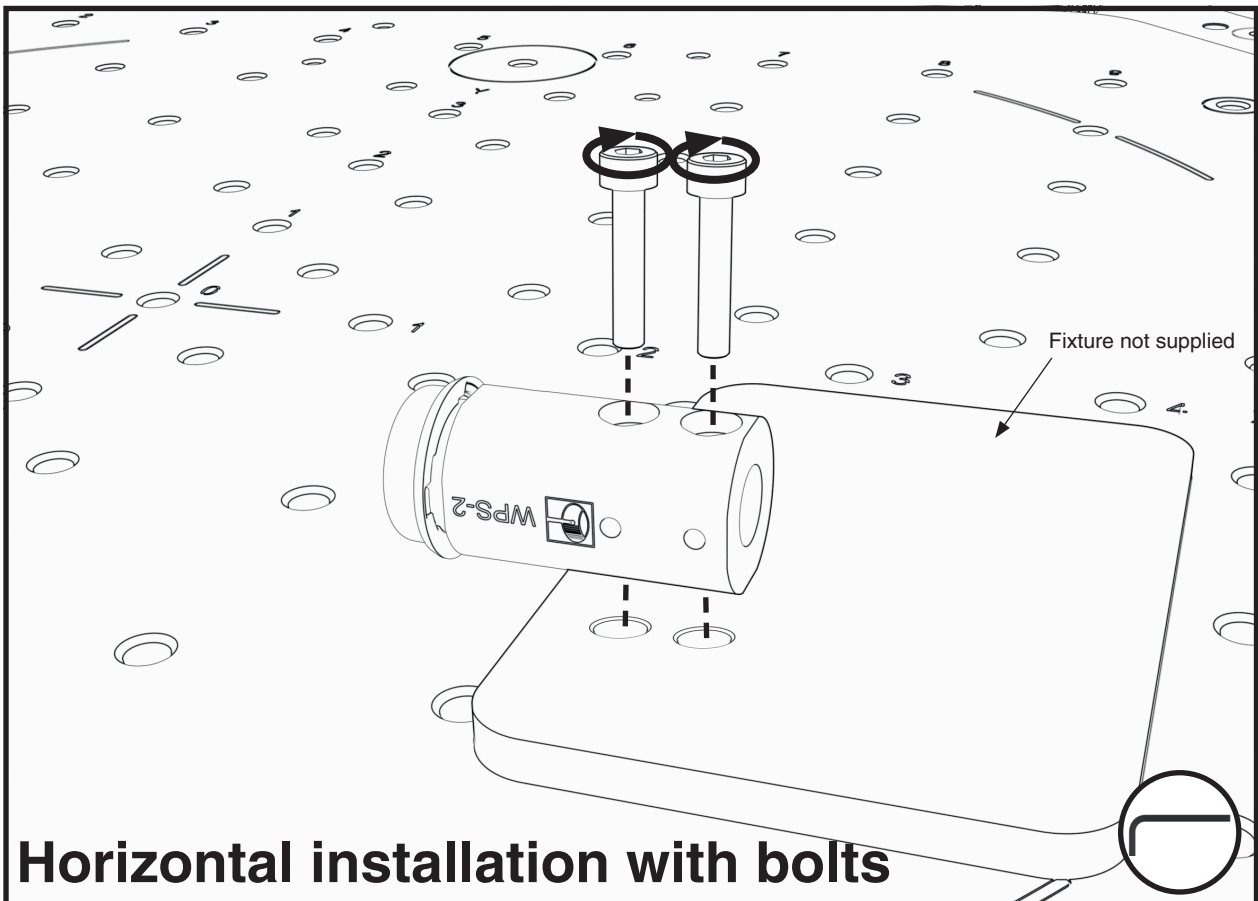

Horizontal installation with bolts

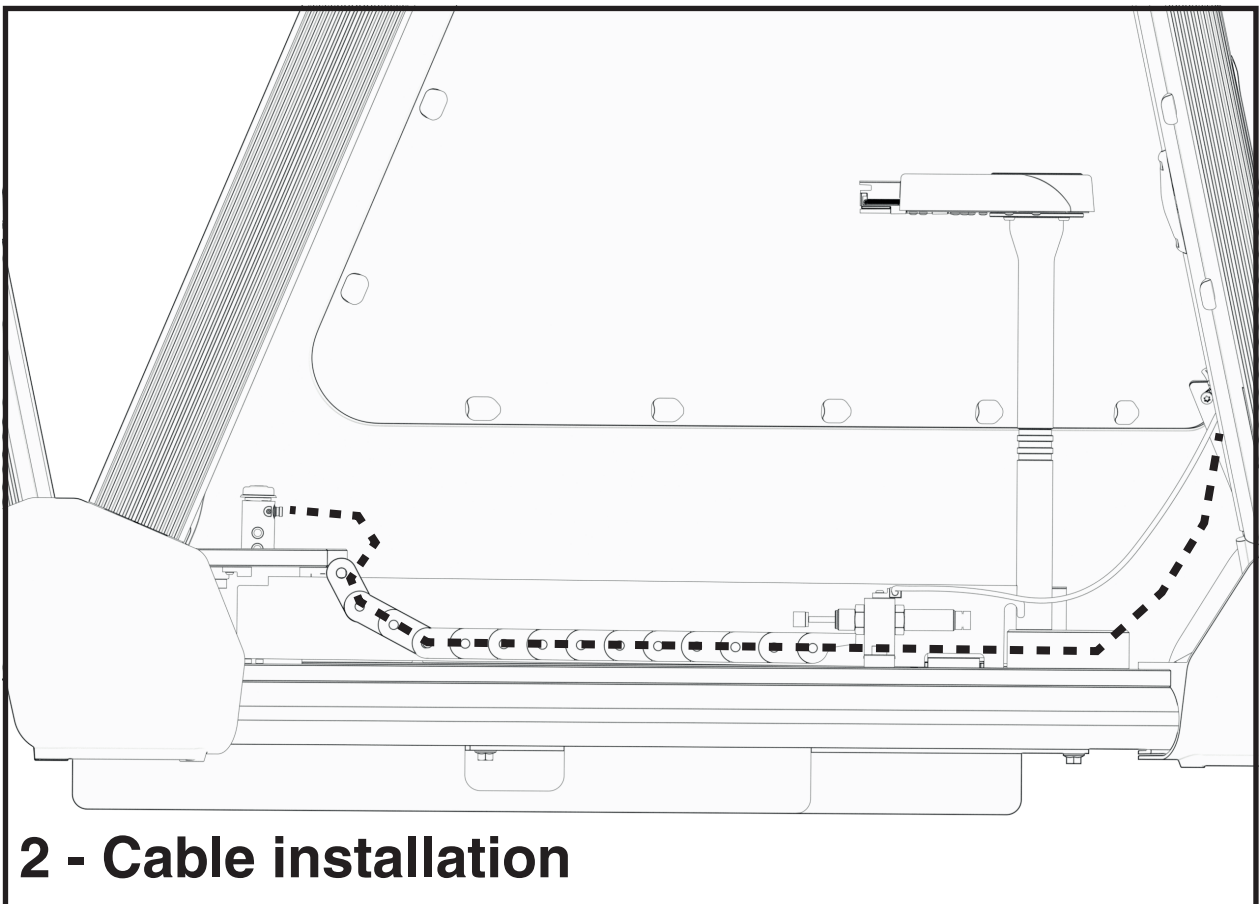
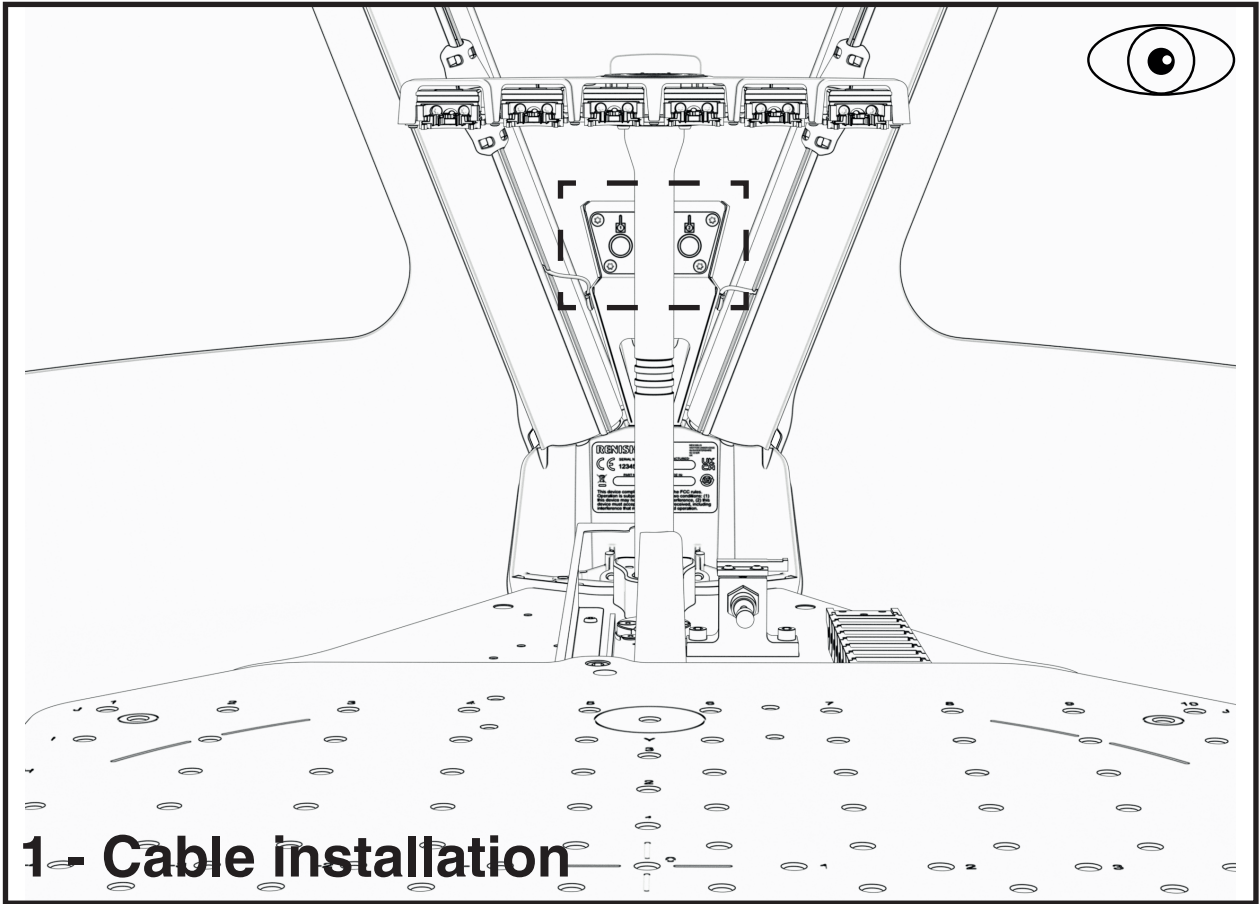

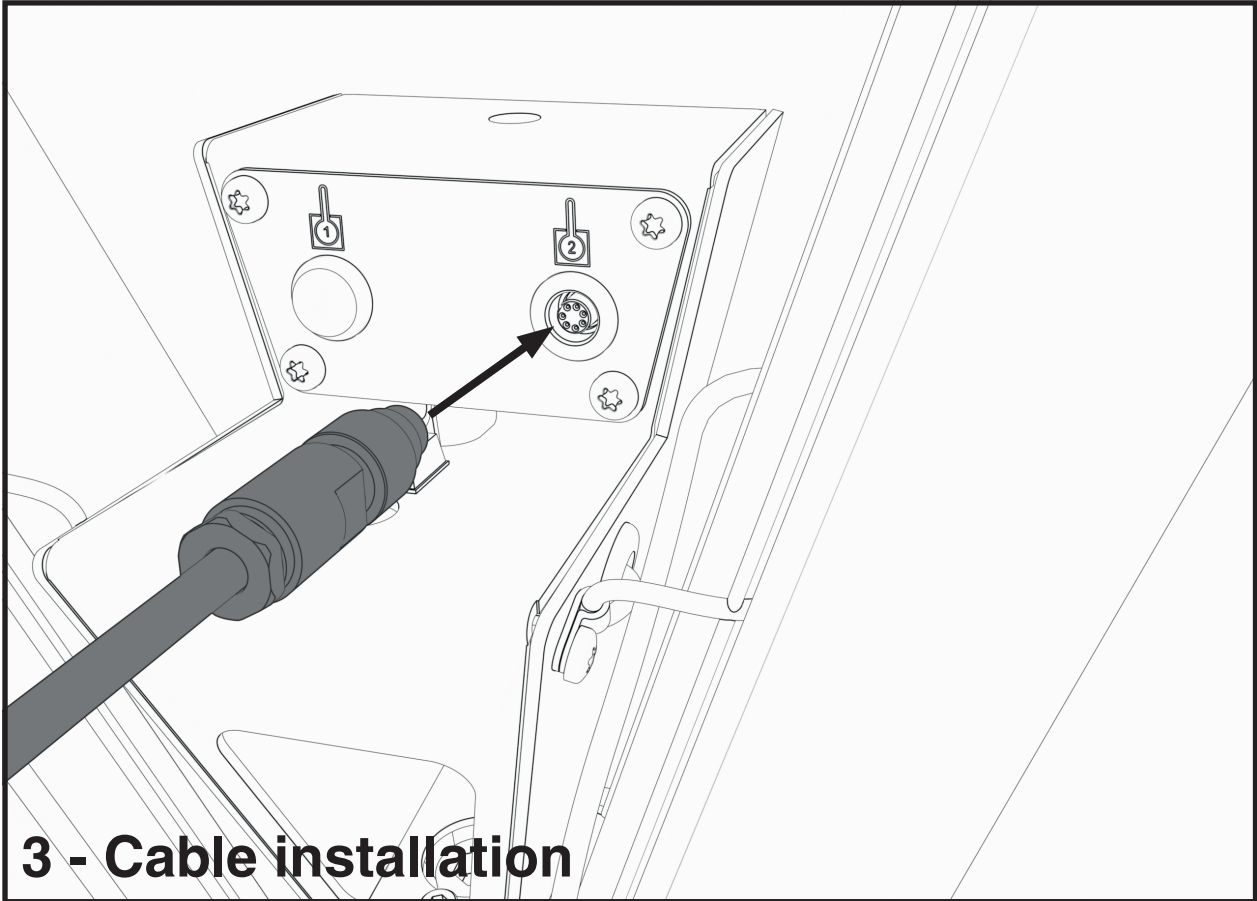

www.renishaw.com/gauging



#renishaw

 +44 (0) 1453 524524

 uk@renishaw.com

© 2025 Renishaw plc. All rights reserved. This document may not be copied or reproduced in whole or in part, or transferred to any other media or language by any means, without the prior written permission of Renishaw.

RENISHAW® and the probe symbol are registered trade marks of Renishaw plc. Renishaw product names, designations and the mark 'apply innovation' are trade marks of Renishaw plc or its subsidiaries. Other brand, product or company names are trade marks of their respective owners.

WHILE CONSIDERABLE EFFORT WAS MADE TO VERIFY THE ACCURACY OF THIS DOCUMENT AT PUBLICATION, ALL WARRANTIES, CONDITIONS, REPRESENTATIONS AND LIABILITY, HOWSOEVER ARISING, ARE EXCLUDED TO THE EXTENT PERMITTED BY LAW. RENISHAW RESERVES THE RIGHT TO MAKE CHANGES TO THIS DOCUMENT AND TO THE EQUIPMENT, AND/OR SOFTWARE AND THE SPECIFICATION DESCRIBED HEREIN WITHOUT OBLIGATION TO PROVIDE NOTICE OF SUCH CHANGES.

Renishaw plc. Registered in England and Wales. Company no: 1106260. Registered office: New Mills, Wotton-under-Edge, Glos, GL12 8JR, UK.

Part no.: H-6620-8527-01-A

Issued: 04.2025