

LM13 linear magnetic encoder system (DPI)

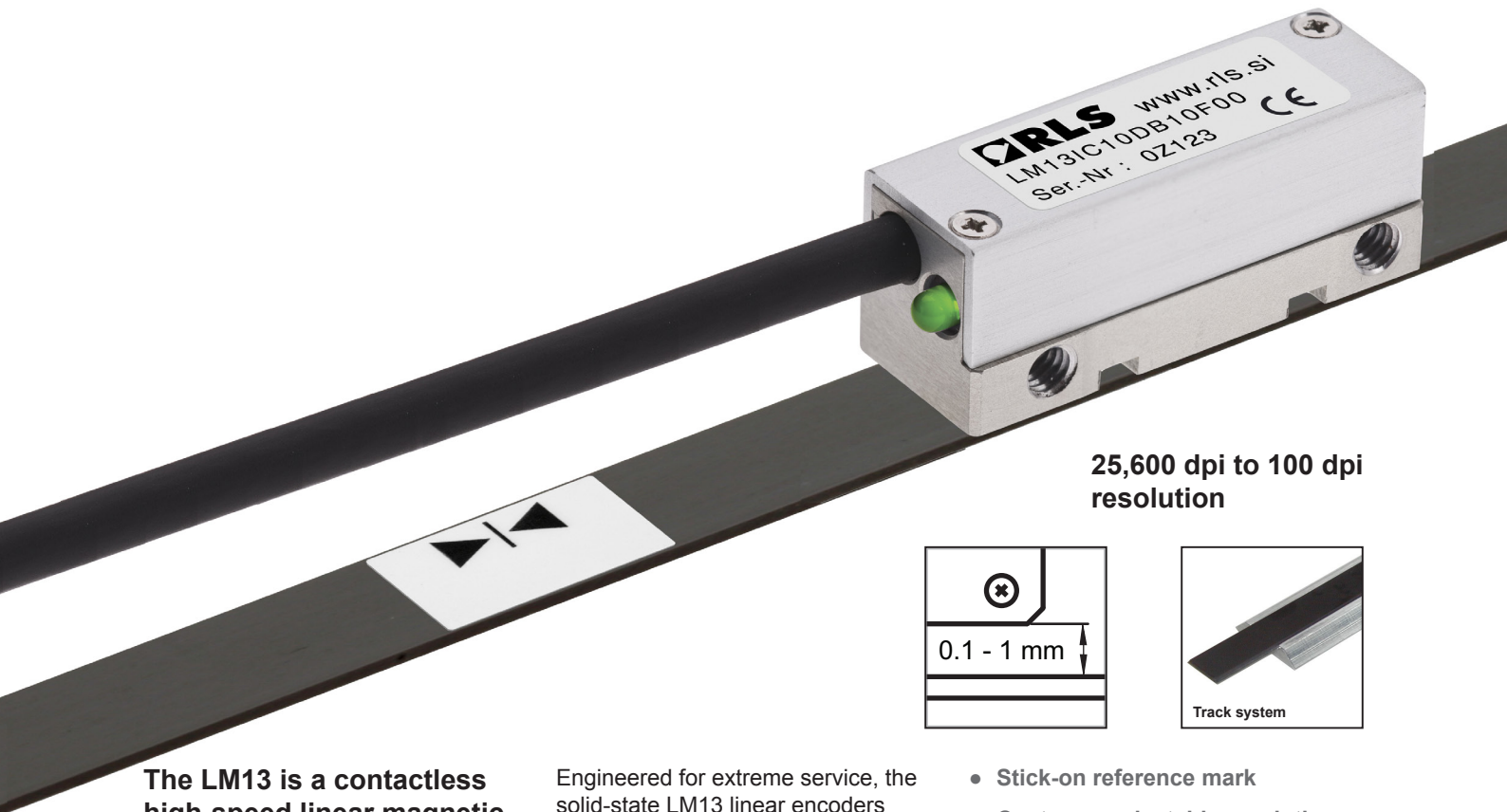

**25,600 dpi to 100 dpi
resolution**

The LM13 is a contactless high-speed linear magnetic encoder designed for DPI applications.

The LM13 features a compact sealed readhead that rides at up to 1.0 mm from the self-adhesive magnetic strip scale, which brings up to 100 m travel.

Simple to install, the LM13 features an integral set-up LED on the readhead, wide installation tolerances and an applicator tool for the adhesive-backed magnetic scale. A bidirectional reference is provided that can be actuated either by a preset mark integrated within the scale or by adding a reference sticker on top of the scale with the help of a self-aligning installation tool.

The encoders come in digital output variants and offer a range of customer selectable resolutions from 25,600 dpi to 100 dpi.

Engineered for extreme service, the solid-state LM13 linear encoders operate from -10 °C to +80 °C, have water-proof sealing to IP68 and are highly resistant to shock, vibrations and pressure. The robust magnetic scale is also resistant to a range of chemicals commonly found in industry.

The non-contact, frictionless design eliminates wear while reducing hysteresis.

- **Stick-on reference mark**
- **Customer selectable resolutions from 25,600 dpi to 100 dpi**
- **High speed operation**
- **Excellent dirt immunity**
- **Integral set-up LED**
- **Axis lengths of up to 100 m**
- **High reliability from proven non-contact sensing technology**
- **Industry standard digital output options**

LM13 dimensions

Dimensions and tolerances in mm.

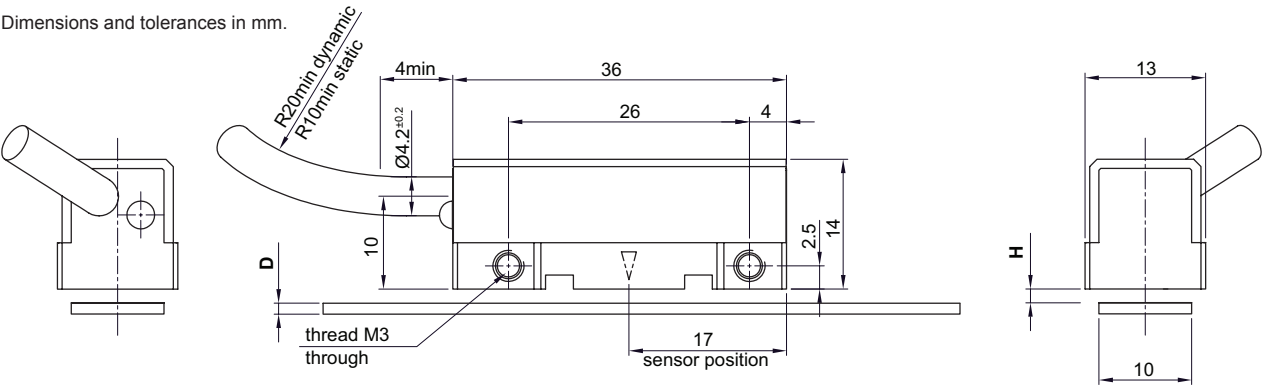

	Magnetic scale thickness (D)	Ride height (H)	
		Maximum range	Recommended range
No cover foil, cut or magnetised reference mark	1.5 ^{-0.2}	0.1 - 1.5	0.1 - 1.0
No cover foil, stick-on reference mark	1.5 ^{-0.2}	0.5 - 1.5	0.5 - 1.0
With cover foil, cut or magnetised reference mark	1.65 ^{-0.2}	0.1 - 1.3	0.1 - 0.9
With cover foil, stick-on reference mark	1.65 ^{-0.2}	0.5 - 1.3	0.5 - 0.9

* For larger ride height (H) please see LM15 linear encoder system (LM15D01).

LM13 installation tolerances

Ride height

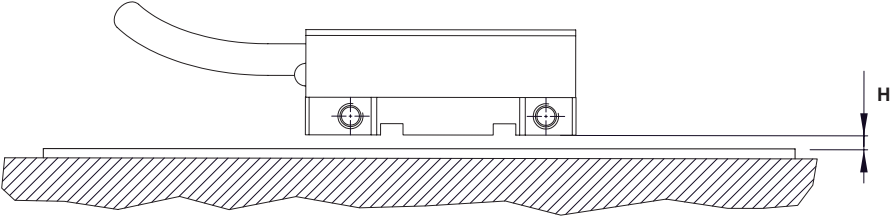

Pitch

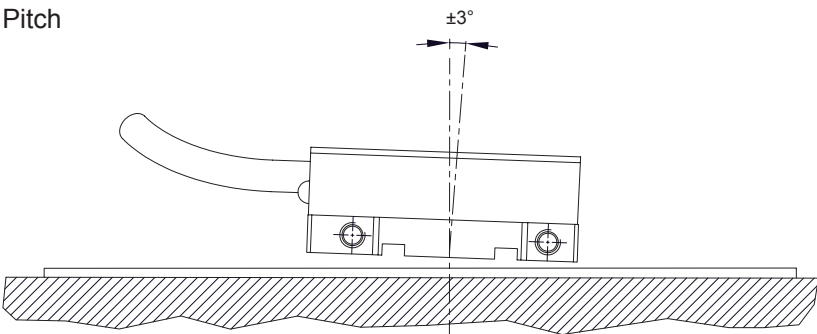

Yaw

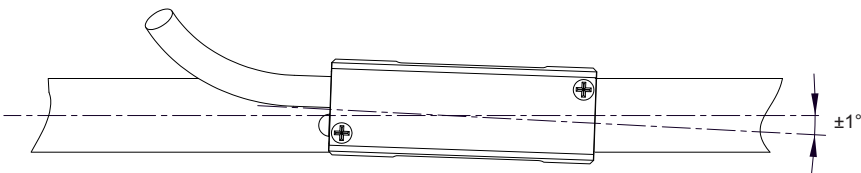

Lateral offset

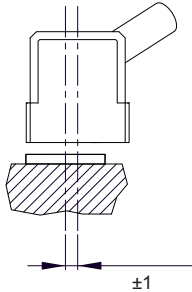

Roll

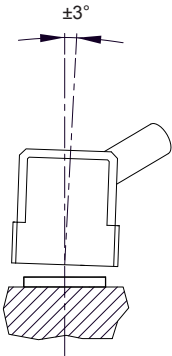

LM13 technical specifications

System data							
Maximum measuring length for MS scale	50 m (100 m special order)						
Pole length	2.032 mm						
Available resolutions	100, 200, 400, 500, 800, 1,000, 1,250, 1,600, 2,000, 2,500, 3,200, 4,000, 5,000, 6,250, 6,400, 10,000, 12,500, 12,800, 20,000, 25,000, 25,600 dpi						
Maximum speed	For analogue voltage output: 25 m/s For digital outputs:						
	Resolution (dpi)	Interpolation factor	Maximum speed (m/s)				
	25,600	2,048	4.11	1.03	0.52	0.25	0.13
	25,000	2,000	4.23	1.06	0.53	0.25	0.13
	20,000	1,600	5.28	1.32	0.66	0.31	0.16
	12,800	1,024	8.24	2.05	1.03	0.49	0.25
	12,500	1,000	8.45	2.11	1.06	0.50	0.26
	10,000	800	10.57	2.63	1.32	0.63	0.32
	6,400	512	16.50	4.11	1.59	0.98	0.50
	6,250	500	16.91	4.23	2.11	1.01	0.52
	5,000	400	21.13	5.28	2.63	1.26	0.64
	4,000	320	25.00	6.60	3.30	1.57	0.81
	3,200	256	25.00	8.24	4.11	1.95	1.01
	2,500	200	25.00	10.57	5.28	2.50	1.29
	2,000	160	25.00	6.60	3.30	1.64	0.81
	1,600	128	25.00	16.50	8.24	3.92	2.00
	1,250	100	25.00	10.57	5.28	2.50	1.29
	1,000	80	25.00	6.60	3.30	1.64	0.81
	800	64	25.00	25.00	16.50	7.85	4.02
	500	40	25.00	6.60	3.30	1.57	0.81
	400	32	25.00	25.00	25.00	15.72	8.05
	200	16	N/A	25.00	25.00	25.00	16.09
	100	8	N/A	25.00	25.00	25.00	25.00
	Edge separation (µs)		0.12	0.50	1	2	4
	Count frequency (kHz)		8333	2000	1000	500	250
Precision class for MS scale	±20 µm/m and ±40 µm/m						
Linear expansion coefficient for MS scale	~ 17 × 10 ⁻⁶ /K						
Hysteresis	< 3 µm up to 0.5 mm ride height						
Repeatability	Better than unit of resolution						
Sub divisional error	±3.5 µm for < 0.7 mm ride height ±7.5 µm for 1 mm ride height						
Mass	Readhead (1 m cable, no connector) 80 g, Cable (1 m) 34 g Magnetic scale (1 m) 60 g, Cover foil (1 m) 3.5 g						
Cable data							
Voltage drop over cable	~ 13 mV/m – without load ~ 54 mV/m – with 120 Ω load						
Cable	Ø4.2 ^{+0.2} mm, PUR high flexible cable, drag-chain compatible, double-shielded 8 × 0.05 mm ² ; durability: 20 million cycles at 20 mm bend radius						
Environmental conditions							
Temperature	Operating	-10 °C to +80 °C (cable under non-dynamic conditions: -20 °C to +85 °C)					
	Storage	-40 °C to +85 °C					
Environmental sealing	IP68 (according to IEC 60529)						
EMC Immunity	IEC 61000-6-2 (particularly: ESD: IEC 61000-4-2; EM fields: IEC 61000-4-3; Burst: IEC 61000-4-4; Surge: IEC 61000-4-5; Conducted disturbances: IEC 61000-4-6; Power frequency magnet fields: IEC 61000-4-8; Pulse magnetic fields: IEC 61000-4-9)						
EMC Interference	IEC 61000-6-4 (for industrial, scientific and medical equipment: IEC 55011)						
Vibrations (55 Hz to 2000 Hz)	300 m/s ² (IEC 60068-2-6)						
Shocks (11 ms)	300 m/s ² (IEC 60068-2-27)						

LM13IC – Digital output signals

Square wave differential line driver to EIA RS422

Power supply *	4.7 V to 7 V – voltage on readhead Reverse polarity protection
Power supply rise time (for PRG option only)	< 1 ms
Power consumption	< 35 mA
Output signals	3 square-wave signals A, B, Z and their inverted signals A-, B-, Z-
Reference signal	1 or more square-wave pulse Z and its inverted pulse Z-
Signal level	Differential line driver to EIA standard RS422: $U_H \geq 2.5 \text{ V}$ at $-I_H = 20 \text{ mA}$ $U_L \leq 0.5 \text{ V}$ at $I_L = 20 \text{ mA}$
Permissible load	$Z_0 \geq 100 \Omega$ between associated outputs $I_L \leq 20 \text{ mA}$ max. load per output Capacitive load $\leq 1000 \text{ pF}$ Outputs are protected against short circuit to 0 V and to +5 V
Alarm	High impedance on output lines A, B, A-, B-
Switching time (10 to 90 %)	t_+ , $t_- < 30 \text{ ns}$ (with 1 m cable and recommended input circuit)
Cable length *	max. 100 m

* Please consider voltage drop over cable.

Timing diagram

Complementary signals not shown

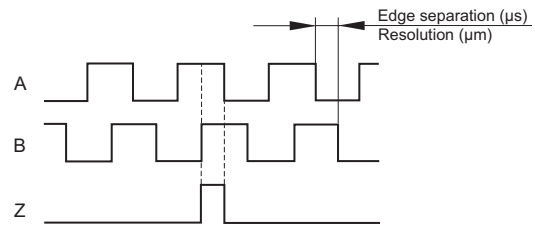

Recommended signal termination

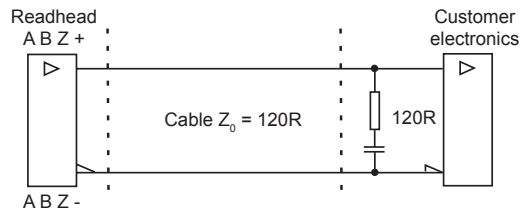

LM13AV – Analogue output signals (1 V_{pp})

2 channels V_1 and V_2 differential sinusoidals (90° phase shifted)

Power supply *	4.7 V to 7 V – voltage on readhead Reverse polarity protection	
Power consumption	< 50 mA	
Output signals	V_1, V_2, V_0	
Sine / cosine signals	Amplitude (with 120 Ω termination)	0.6 V _{pp} to 1.2 V _{pp}
	Phase shift	90° ± 0.5°
Reference signal	Amplitude (with 120 Ω termination)	0.8 V _{pp} to 1.2 V _{pp}
	Position	45°
	Width	22.5°
Termination	$Z_0 = 120 \Omega$ between associated outputs	

* Please consider voltage drop over cable.

Timing diagram

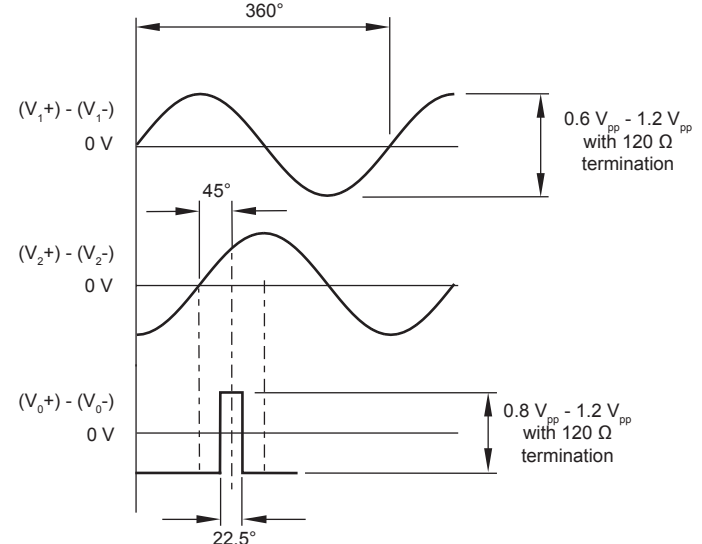

Positive direction

Digital output signals – A leads B

Analogue output signals (1 V_{pp}) – V_1 leads V_2

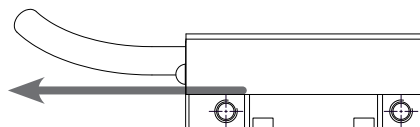

Set-up LED

After the installation of the magnetic scale (see LM13D10) the readhead can be easily adjusted on the machine using the set-up LED indicator.

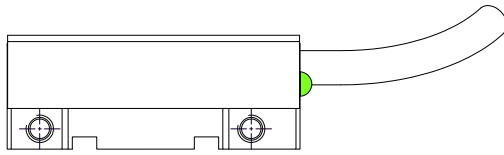

Green LED = good signal strength / set-up

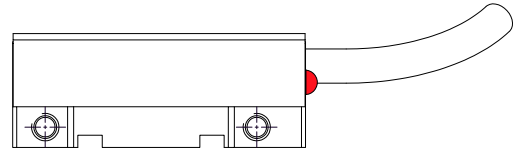

Red LED = poor signal strength - adjustment required
A, B, A-, B- outputs become high impedance

Programming (for IC output type only)

Readheads can be ordered preset to the required resolution or provided so that they can be programmed as needed on the machine to the chosen resolution. This programming is carried out by connecting the readhead to a computer via a programming interface. The readhead must be ordered with the PRG option to use this function.

Reference mark

The repeatable bi-directional reference signal can be provided in 4 ways.

- 1) **Stick-on reference mark.** The LM13 readhead should be ordered with the reference mark option. After installation of the scale a reference mark sticker can be applied to the scale at the required position using the reference mark applicator tool. Ensure that the reference mark sticker is oriented to the corresponding side of the readhead that has the reference mark designator marked.

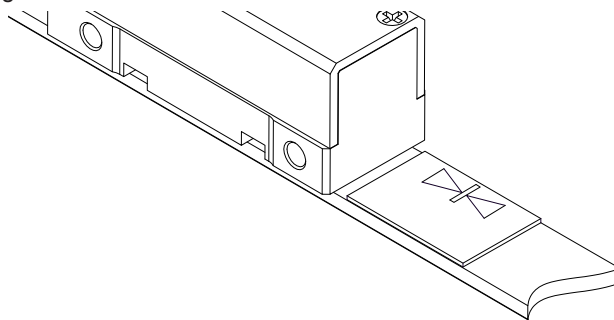

- 2) **Selected at point of order.** The LM13 readhead should be ordered with the reference mark option. If required, the cover foil can be installed over the cut reference mark.

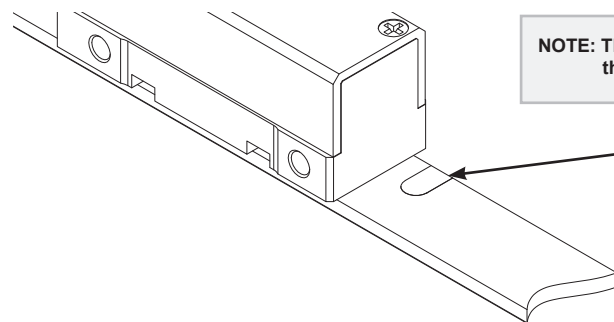

NOTE: The shape of the cut and position is critical so this option is only available as factory order.

Cut reference mark

- 3) **Every 2.032 mm.** The LM13 readhead should be ordered with this specific mode activated only.

- 4) **Distance coded reference mark.** The distance coded reference mark option provides multiple reference marks that are individually spaced according to specific mathematical algorithm. Absolute position is calculated after traversing 2 successive reference marks. Maximum length and minimal traverse depend on basic spacing (K) between reference marks, which is customer selectable at point of order. For further information please refer to Distance coded reference mark data sheet (LM10D17).

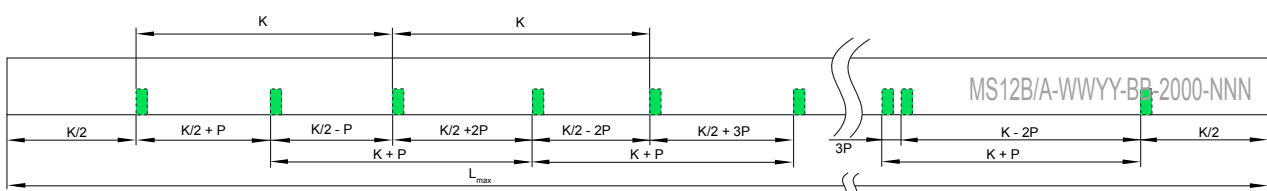

LM13 readhead part numbering

LM13 DPI system

=

Readhead



Readhead part number
eg **LM13IC10DCA10F05**

+

Scale



Magnetic scale part number
eg **MS12B1000B0032**

LM13 IC 2D0 C A 10 F 05

Output type

IC - Incremental, RS422; 5 V power supply
AV - Analogue voltage, 1 V_{pp}; 5 V

Resolution

000 - for **AV** output type

For **IC** output type

11B - 25,600 dpi	D20 - 2,500 dpi
2D0 - 25,000 dpi	D16 - 2,000 dpi
1D6 - 20,000 dpi	07B - 1,600 dpi
10B - 12,800 dpi	D10 - 1,250 dpi
1D0 - 12,500 dpi	D08 - 1,000 dpi
D80 - 10,000 dpi	06B - 800 dpi
09B - 6,400 dpi	D04 - 500 dpi
D50 - 6,250 dpi	05B - 400 dpi
D40 - 5,000 dpi	04B - 200 dpi
D32 - 4,000 dpi	03B - 100 dpi
08B - 3,200 dpi	PRG - Programmable from 25,600 dpi to 100 dpi (preset to 25,000 dpi)

Minimum edge separation

For **AV** output type

A - N/A

For **IC** output type

A - 0.12 µs (8.3 MHz)*
B - 0.5 µs (2 MHz)
C - 1 µs (1 MHz)
D - 2 µs (0.5 MHz)
E - 4 µs (0.25 MHz)

Special requirements

05 - 2.032 mm pitch

Connector option

A - 9 pin D type plug
D - 15 pin D type plug (for **IC** output type)
L - 15 pin D type plug (for **AV** output type)
H - 15 pin HD type plug (for **IC** output type)
P - 9 pin D type plug (for **AV** output type)
F - Flying lead (no connector)

Cable length

10 - 1.0 m (standard)

Reference

A - With reference
B - No reference
C - Periodic as per scale pitch

* Default for **PRG** option.

NOTE: Not available with 100 dpi and 200 dpi resolution options.

Magnetic scale part numbering

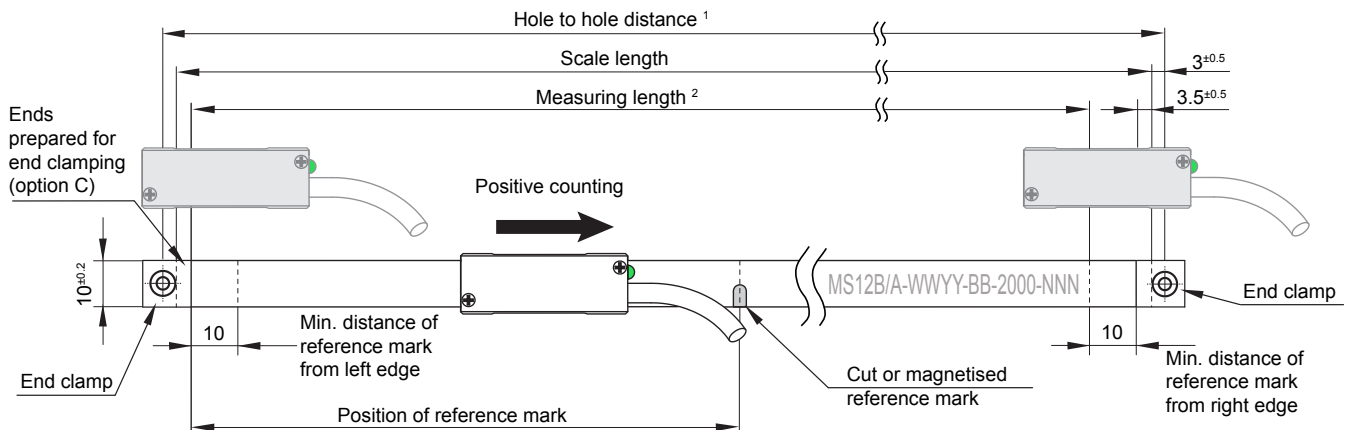

¹ Hole to hole distance = scale length + 6^{±1} mm (for end clamp mounting)

² Measuring length = scale length - 17 mm

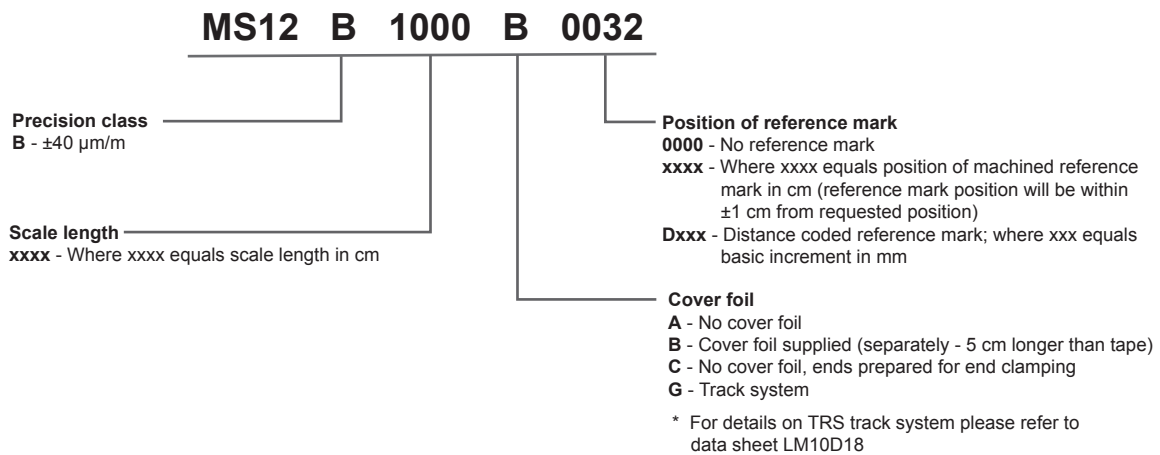

Accessories part numbering

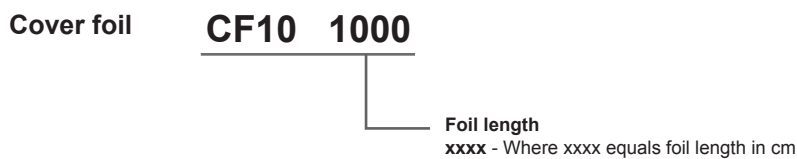

Stick-on reference mark	LM10SRM00
Applicator tool for stick-on reference mark	LM10ARM00
Applicator tool for magnetic scale and cover foil	LM10ASC00
End clamp kit (2 clamps + 2 screws)	LM10ECL00

Head office

RLS merilna tehnika d.o.o.
Poslovna cona Žeje pri Komendi
Pod vrbami 2
SI-1218 Komenda
Slovenia

T +386 1 5272100
F +386 1 5272129
E mail@rls.si
www.rls.si

Document issues

Issue	Date	Page	Corrections made
1	6. 1. 2009	-	New document
2	5. 5. 2011	2	Ride height table added
		5	DCRM added to reference mark options
		6	AV output type and HD connector option added
		7	End clamp option added to technical drawing; track system and DCRM option added

RENISHAW  is our worldwide sales support partner for Magnetic Encoders.

Australia
T +61 3 9521 0922
E australia@renishaw.com

Austria
T +43 2236 379790
E austria@renishaw.com

Brazil
T +55 11 4195 2866
E brazil@renishaw.com

Canada
T +1 905 828 0104
E canada@renishaw.com

The People's Republic of China
T +86 10 8448 5306
E beijing@renishaw.com

Czech Republic
T +420 5 4821 6553
E czech@renishaw.com

France
T +33 1 64 61 84 84
E france@renishaw.com

Germany
T +49 7127 9810
E germany@renishaw.com

Hong Kong
T +852 2753 0638
E hongkong@renishaw.com

Hungary
T +36 23 502 183
E hungary@renishaw.com

India
T +91 20 6674 6751
E india@renishaw.com

Israel
T +972 4 953 6595
E israel@renishaw.com

Italy
T +39 011 966 10 52
E italy@renishaw.com

Japan
T +81 3 5366 5316
E japan@renishaw.com

The Netherlands
T +31 76 543 11 00
E benelux@renishaw.com

Poland
T +48 22 577 11 80
E poland@renishaw.com

Russia
T +7 495 231 1677
E russia@renishaw.com

Singapore
T +65 6897 5466
E singapore@renishaw.com

Slovenia
T +386 1 52 72 100
E mail@rls.si

South Korea
T +82 2 2108 2830
E southkorea@renishaw.com

Spain
T +34 93 663 34 20
E spain@renishaw.com

Sweden
T +46 8 584 90 880
E sweden@renishaw.com

Switzerland
T +41 55 415 50 60
E switzerland@renishaw.com

Taiwan
T +886 4 2473 3177
E taiwan@renishaw.com

UK
T +44 1453 524524
E uk@renishaw.com

USA
T +1 847 286 9953
E usa@renishaw.com

**For all other countries
please contact RLS'
head office**

T +386 1 52 72 100
E mail@rls.si