

Linex Manufacturing overcomes inspection challenges by introducing metal 3D printed custom stylus on Equator™ gauging system



Customer:

Linex Manufacturing
(Canada)

Industry:

Automotive

Challenge:

To accurately inspect difficult-to-reach features on automotive parts.

Solution:

Equator 300 flexible gauge with additively manufactured custom stylus.

A move to Renishaw's Equator™ 300 automated gauging system gave Linex Manufacturing all the inspection speed and accuracy it needed. However, on a project implemented before the larger Equator™ 500 was available, bolt holes on the extremities of a workpiece lay just outside the gauge's working envelope. When standard styli and stylus extensions could not reach, an additively manufactured custom stylus provided the answer.

Background

Linex Manufacturing is a division of Linamar Corporation, one of the world's leading automotive parts manufacturers, which uses multiple Equator flexible gauges at many global production plants. At its base in Ontario, Canada, Linex produces a range of precision-machined automotive components.

Its core business lies in the production of automatic transmission components used in medium- and heavy-duty commercial vehicles. Its customers are global transmission manufacturers, and production volumes are high.

Linex first purchased two Equator 300 gauging systems in 2015. When a major new product launch required continuous 5-day working with three rotating 8-hour shifts, Linex decided to buy four more Equator 300 gauges in 2017 to keep pace with the elevated production levels.



Narcis Georgescu, Senior Quality Supervisor (right) consults with Renishaw applications engineer



Inspecting automotive component on Equator 300 with additively manufactured stylus

Capable of component scanning speeds in excess of 200 mm/s and maintaining high accuracy over the temperature range of 5 °C to 50 °C, the Equator 300 provided Linex Manufacturing with a versatile diametric inspection volume of 300 mm to a height of 150 mm, capable of supporting workpiece weights up to 25 kg.

The Equator gauges were tasked with performing high duty-cycle in-process inspection of a wide range of production processes and customer-critical part features. The gauges also helped free up the availability of Linex's quality laboratory CMMs (coordinate measurement machines).

Since this project, Linex became the first company in Canada to operate Renishaw's Equator 500, an automated gauging system with an even bigger working envelope, inspecting automotive workpieces up to four times heavier.

Challenge

Introducing the Equator gauging systems to Linex' shop floor had a significant positive impact on productivity, increased production capability and inspection process throughput.

Narcis Georgescu, Senior Quality Supervisor at Linex Manufacturing, explained one unexpected challenge, "For one component in particular - a front support assembly - we needed to closely inspect a series of 11 mm bolt holes required for mating to another component. Precision was paramount, and they had to be inspected thoroughly. The challenge we faced was that these bolt holes lay just outside of the Equator 300 working envelope."

"Initially, to overcome this challenge, a unique L-shaped tool configuration was produced with multiple components that could help extend this volume and provide us with the inspection access we needed. While it seemed to worked well, over time, it was causing an unexpected measurement uncertainty."



The AM stylus' impact on productivity has been profound. It means that we now have complete assurance that we will avoid any costly rejections, due to either bolt hole size or position being out of spec. Now we have accuracy and repeatability in our bolt hole inspections that remain within acceptable limits and irrespective of ambient conditions, stability stays within a 5% limit.



Linex Manufacturing (Canada)

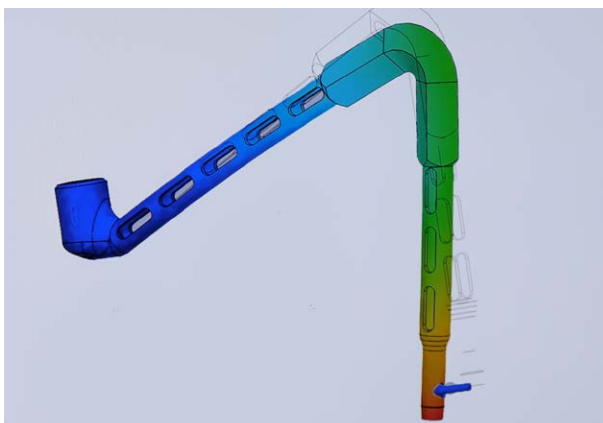

Additively manufactured custom stylus design

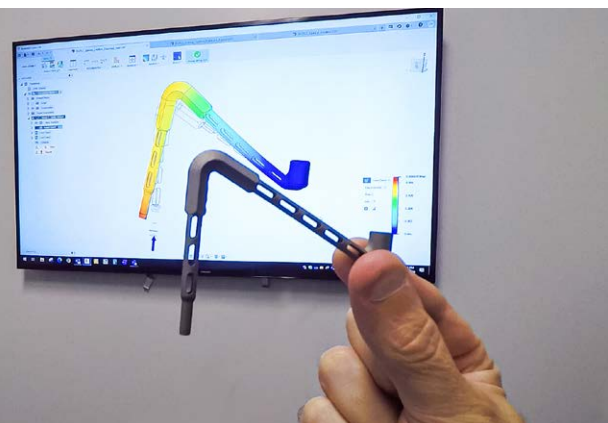

Solution

Thorough metrological testing of the Equator system carried out with Renishaw engineers verified the repeatability of the gauge itself. It confirmed the need for a robust stylus construction for specifically inspecting the bolt holes.

Determining that a probing setup using multiple components did not provide the necessary rigidity, Renishaw proposed the development of a custom stylus using metal additive manufacturing (AM), also known as metal 3D printing.

Conceived digitally in 3D CAD software and printed at Renishaw's Solutions Centre in Ontario, Canada, an elegant Z-shaped stylus was produced as a single-piece monolithic construction with internal latticework to reduce its weight and avoid the risk of false triggers.

The stylus was rapidly printed with a high-strength titanium alloy powder on a Renishaw RenAM 500Q metal additive manufacturing system using a process known as metal powder bed fusion, or laser melting.

By avoiding traditional manufacturing techniques such as casting, forging and machining, Renishaw provided a complex, single-piece stylus solution to Linex quickly.

Results

The introduction of the custom-designed, additively manufactured stylus brought Linex the accuracy and repeatability it needed to inspect component bolt holes outside the Equator 300 gauge's working envelope.

Narcis Georgescu said, "Thanks to its robust, one-piece design, the titanium AM stylus has enabled us to carry out full component inspections. It brings a combination of lightness and stiffness that we could not achieve."

A few years on and the original AM stylus is still running without any degradation in its performance. Linex purchased a second AM stylus in the exact same design, and the company is now operating six Equator 300 gauges and one larger Equator 500 gauge.



Custom stylus metal 3D printed on a RenAM 500Q system

For more information visit, www.renishaw.com/customstyli

Renishaw plc
New Mills, Wotton-under-Edge
Gloucestershire, GL12 8JR
United Kingdom

T +44 (0) 1453 524524
F +44 (0) 1453 524901
E uk@renishaw.com
www.renishaw.com

For worldwide contact details, visit www.renishaw.com/contact

WHILE CONSIDERABLE EFFORT WAS MADE TO VERIFY THE ACCURACY OF THIS DOCUMENT AT PUBLICATION, ALL WARRANTIES, CONDITIONS, REPRESENTATIONS AND LIABILITY, HOWSOEVER ARISING, ARE EXCLUDED TO THE EXTENT PERMITTED BY LAW.

RENISHAW RESERVES THE RIGHT TO MAKE CHANGES TO THIS DOCUMENT AND TO THE EQUIPMENT, AND/OR SOFTWARE AND THE SPECIFICATION DESCRIBED HEREIN WITHOUT OBLIGATION TO PROVIDE NOTICE OF SUCH CHANGES.

© 2022 Renishaw plc. All rights reserved. This document may not be copied or reproduced in whole or in part, or transferred to any other media or language by any means, without the prior written permission of Renishaw.
RENISHAW® and the probe symbol are registered trade marks of Renishaw plc. Renishaw product names, designations and the mark 'apply innovation' are trade marks of Renishaw plc or its subsidiaries. Other brand, product or company names are trade marks of their respective owners.
Renishaw plc. Registered in England and Wales. Company no: 1106260. Registered office: New Mills, Wotton-under-Edge, Glos, GL12 8JR, UK.

Part no.: H-5650-0073-01-A
Issued: 06.2022