

# Controller requirements: Productivity+™ Scanning Suite

## Siemens 840D solution line

The information within this document provides the minimum recommended controller requirements to enable the use of a SPRINT™ system with Productivity+™ on a machining centre with a Siemens 840D solution line controller.

---

**NOTE:** Part numbers and descriptions within this document relating to items provided by organisations other than Renishaw are provided for information only. Whilst every effort has been made to ensure these are accurate, contact the machine tool builder, controller OEM or distributor for confirmation before purchasing.

---

# CNC plug-in installations

NCU version 2.6 service pack 1, hotfix 8 or later<sup>1</sup>

Controller option	
Synchronized actions stage 2	
SINUMERIK Integrate Run MyHMI / 3GL software option P60 (option number 6FC5800-0AP60-0YB0) or SINUMERIK Integrate Run MyHMI / 3GL (for Siemens Solution Partners) option P65 (option number 6FC5800-0AP65-0YB0) or SINUMERIK Operate Runtime licence OA .net software option P66 (option number 6FC5800-0AP66-0YB0)	
1 × high-speed digital input (utilises SETINT command on DI0–DI7 only)	
COrelated Position Access (COPA) compile cycle (recommended) (contact Siemens for option number) and SINUMERIK Integrate Run MyCC / COPA option (option number 6FC5800-0AN61-0YB0) <sup>2</sup>	<b>OR</b>
1 × high-speed probe sensor input	Measurement stage 2 (contact Siemens for option number)
4 × high-speed digital outputs <sup>2</sup>	2 × high-speed probe sensor inputs
MD 10061 \$MN_POSCTRL_CYCLE_TIME < 0.005 <sup>3</sup>	3 × high-speed digital outputs

Application-dependent options	For use with
TRAORI	Productivity+™ Machine Health Check
CYCLE800	5-axis prismatic measurement

<sup>1</sup> For earlier NCU versions, contact Renishaw.

<sup>2</sup> The first two on-board digital outputs (\$A\_OUT[1] and \$A\_OUT[2]) of the solution line 840D NCU are high-speed digital outputs and must be reserved for the Productivity+ system. (The COrelated Position Access (COPA) compile cycle uses these digital outputs exclusively.)

<sup>3</sup> When using COPA it is recommended that machine parameter 10061 \$MN\_POSCTRL\_CYCLE\_TIME is less than (or equal to) 0.005 (seconds). If 10061 \$MN\_POSCTRL\_CYCLE\_TIME is greater than 0.005 (seconds), measurement feedrate should be reduced to maintain accuracy.

In addition to the Productivity+ CNC plug-in, a series of optional toolkits are available providing enhanced functionality.

Typically, run-time elements of the Productivity+ Scanning Suite are installed on an external data processor. Use of a Renishaw DPU-2 (Renishaw part no. A-5465-4002) is recommended.

The minimum recommended specification for any alternative external data processor (PC) is:

- Microsoft® Windows® 10 (Enterprise or Professional)
- Intel Core i3-5010U
- 2.1 GHz, 2 cores, 4 threads
- 4 GB RAM
- 64 GB solid state drive
- Two 100/1000Base-T Ethernet connections (dedicated to Productivity+). If a customer specific network connection is required, an additional Ethernet connection is required

**NOTE:** It is possible to install onto an external data processor with a lower specification, however this is the minimum recommended specification based on the data processing requirements of Productivity+ software applications.

## Connection schematic

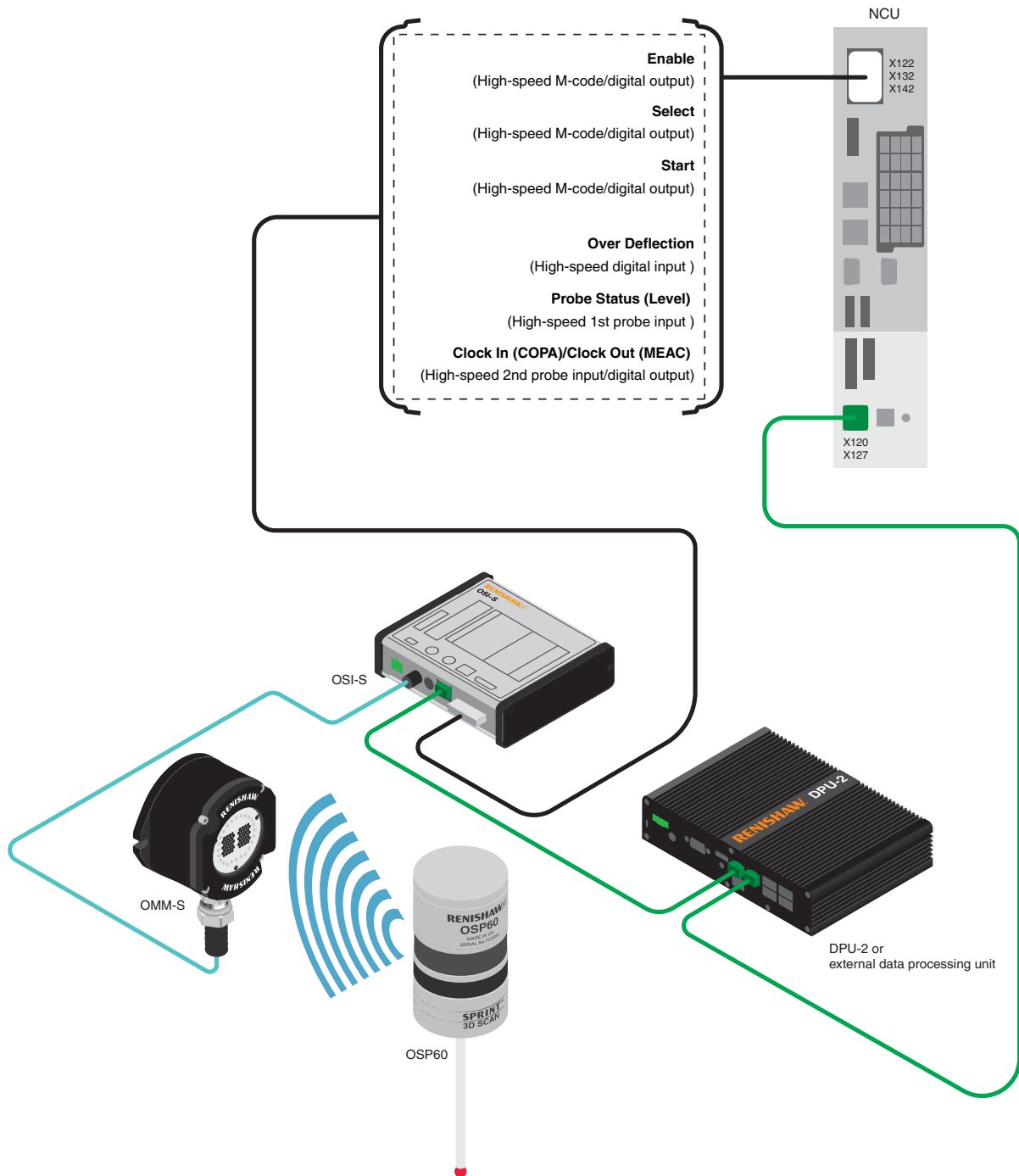

## Output signal requirements

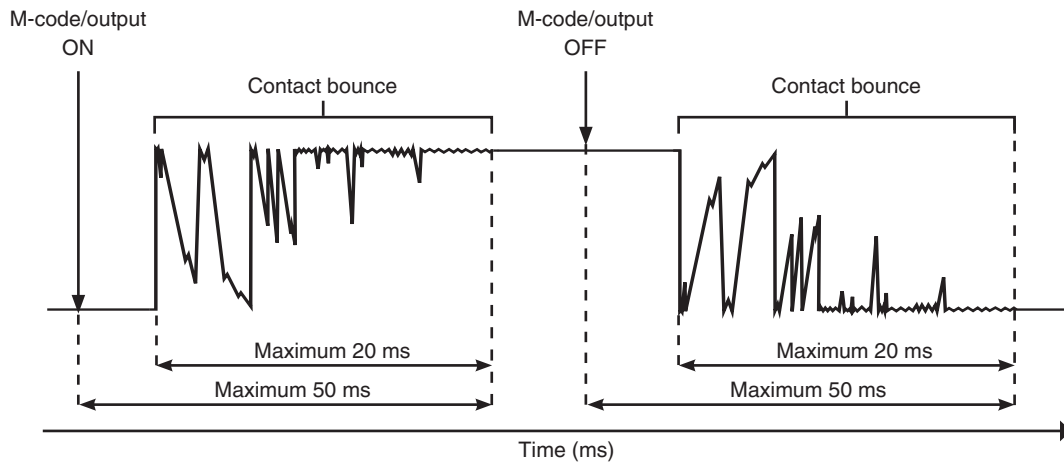

Any increase in these values will impact negatively on cycle times and may prevent the system working reliably.

The 3 × pairs of latched M-codes (high-speed digital outputs) should be reset when Reset is pressed on the CNC machine tool.

The output/input signal level change must be from 0 V to between 5 V and 30 V.

Use of solid-state relays is recommended as issues can arise from noise on mechanical relay contacts (contact debounce time of 20 ms maximum).

[www.renishaw.com/scanningsuite](http://www.renishaw.com/scanningsuite)



#renishaw

+44 (0) 1453 524524

uk@renishaw.com

© 2013–2022 Renishaw plc. All rights reserved. This document may not be copied or reproduced in whole or in part, or transferred to any other media or language by any means, without the prior written permission of Renishaw.

RENISHAW® and the probe symbol are registered trade marks of Renishaw plc. Renishaw product names, designations and the mark 'apply innovation' are trade marks of Renishaw plc or its subsidiaries. Other brand, product or company names are trade marks of their respective owners.

WHILE CONSIDERABLE EFFORT WAS MADE TO VERIFY THE ACCURACY OF THIS DOCUMENT AT PUBLICATION, ALL WARRANTIES, CONDITIONS, REPRESENTATIONS AND LIABILITY, HOWSOEVER ARISING, ARE EXCLUDED TO THE EXTENT PERMITTED BY LAW. RENISHAW RESERVES THE RIGHT TO MAKE CHANGES TO THIS DOCUMENT AND TO THE EQUIPMENT, AND/OR SOFTWARE AND THE SPECIFICATION DESCRIBED HEREIN WITHOUT OBLIGATION TO PROVIDE NOTICE OF SUCH CHANGES.

Renishaw plc. Registered in England and Wales. Company no: 1106260. Registered office: New Mills, Wotton-under-Edge, Glos, GL12 8JR, UK.

Part no.: H-5465-8506-09-C

Issued: 08.2022